



## Specification Sheet Model LB2XL Commercial Clothes Dryer Booster Fan

Job Name: \_\_\_\_\_

Equipment Rep: \_\_\_\_\_

Contractor: \_\_\_\_\_

Tjernlund Contact: \_\_\_\_\_

Arch./Engr.: \_\_\_\_\_

Date: \_\_\_\_\_

### Description:

The LB2XL maintains clothes dryer exhaust air velocities at proper levels when dryer exhaust duct lengths exceed dryer manufacturer recommendations. Suitable for up to 120 equivalent feet of 4" duct.

### Housing:

22 gauge G90 galvanized steel. Features rubber isolated mounting brackets which minimize vibration transfer.

### Control:

Automatically activates fan based on operation of dryer. An LED indicator panel, mounted near the dryer, displays operational status and faults. It communicates via a factory-connected low voltage cable to an on-board booster fan control. The proprietary control monitors pressure and temperature within the duct to operate the booster fan in sync with the dryer and to stop booster fan operation if duct temperature is excessive or signal if the duct becomes blocked.

### Material Handling Impeller:

The Lint Blitzer™ reverse inclined, particulate handling Impeller repels lint. 18 gauge G90 galvanized steel.

### Motor:

PSC, permanently lubricated ball bearing motor is located outside the dryer exhaust air stream to prevent exposure to heat, lint and moisture.

### Installation Notes:

Can be installed with discharge in horizontal or vertical orientations. Vertical orientations must discharge facing up.

Suitable for installation in ambient temperatures between: -20° F and 140° F ( -29° C and 60° C). Suitable for dryer duct temperatures up to 167° F (75° C).

### Warranty:

Five (5) year, no-clog guarantee & warranty

### Typical Specification:

Dryer Exhaust Duct Power Ventilator (DEDPV) shall be Tjernlund Products LB2XL.

The DEDPV shall have a (5) year material, workmanship and no-clog warranty.

The DEDPV shall have a galvanized steel, reverse inclined Impeller that will not clog with lint.

The motor of the DEDPV shall be located outside of the dryer exhaust air stream.

The DEDPV shall include a notification panel that indicates operational status and alerts user to duct blockage, fan malfunction or elevated exhaust duct temperature.

The DEDPV shall include a redundant one shot thermal fuse that can stop operation of the DEDPV independent of the controller's logic status.

### Optional Equipment:

LT4 - 4" Secondary Dryer Lint Trap

### Dimensions:

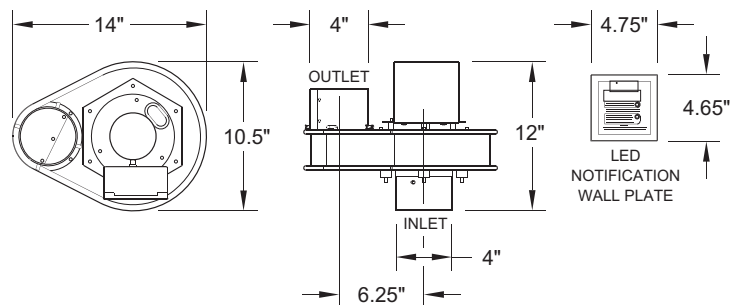

### Specifications:

MODEL LB2XL				
Volts	Amps	Watts	RPM	CFM
120	0.92	110	3300	230

